

PLANO-LOCK2-ONE

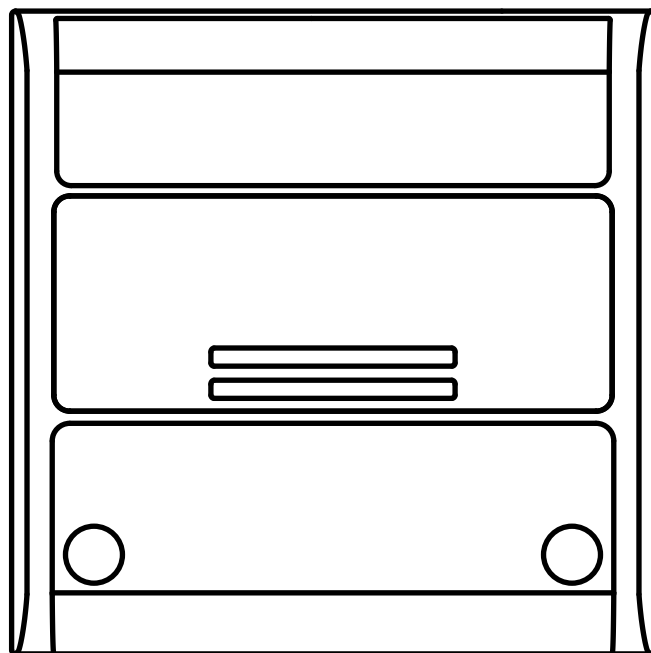

**Electronic interface unit for devices with dry contact inputs (e.g. sectional doors or automated gates).
Power supply 12-32Vdc or 12-24Vac, Two normally open output contacts: 1A 30Vdc.
Integrated 433.92MHz radio receiver for remote controls.
WiFi connection for OneSmart App.**

INDEX

1 - PRODUCT FEATURES	
1.1 - TECHNICAL DATA	page 3
<hr/>	
2 - CONNECTION DIAGRAMS	
2.1 - START CONTACT CONNECTION DIAGRAM	page 4
<hr/>	
3 - USE OF THE CONTROL UNIT	
3.1 - TYPICAL INSTALLATION	page 6
3.2 - USE VIA RADIO	page 7
3.3 - USE WITH SMARTPHONE APPLICATION	page 7
3.4 - USE WITH VOICE CONTROL	page 7
<hr/>	
4 - CONTROL BY RADIO TRANSMITTERS	
4.1 - RADIOTRANSMITTER SETTING	page 8
4.2 - DELETION OF RADIOTRANSMITTERS	page 9
<hr/>	
5 - CONTROL WITH APP ONE SMART	
5.1 - APP ONE SMART CONNECTION	page 10
5.2 - USE OF THE APP ONE SMART	page 11
<hr/>	
6 - CONTROL BY VOICE COMMANDS	
6.1 - CONNECTION TO THE APP "GOOGLE HOME"	page 12
6.2 - CONNECTION TO THE APP "AMAZON ALEXA"	page 13
6.3 - USING VOICE CONTROLS	page 14
<hr/>	
7 - ADVANCED PROGRAMS	
7.1 - VISUALIZATION OF THE STATE OF THE DOOR ON THE APP	page 16
7.2 - RESET	page 20

1 - PRODUCT FEATURES

1.1 TECHNICAL DATA

Power supply	12-32 Vdc or 12-24Vac
Output	One NO contact (1A 30Vdc) for start function of the automation 1 One NO contact (1A 30Vdc) for start function of the automation 2
Status signaling inputs	1 input for automation 1 signaling dry contacts, 1 input for automation 2 signaling dry contacts
N° of programmable transmitters	30
RF receiver frequency	433.920MHz
WiFi frequency	2.4GHz
Protection rating	IP20
Working temperature	-20° +55°
Box dimensions	80 X 80 h16 mm

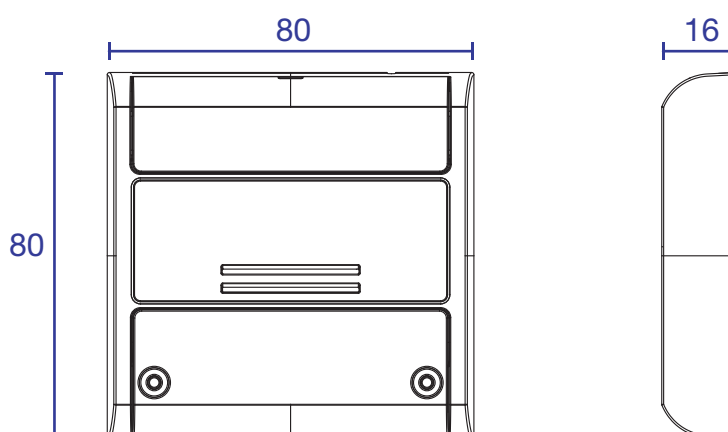
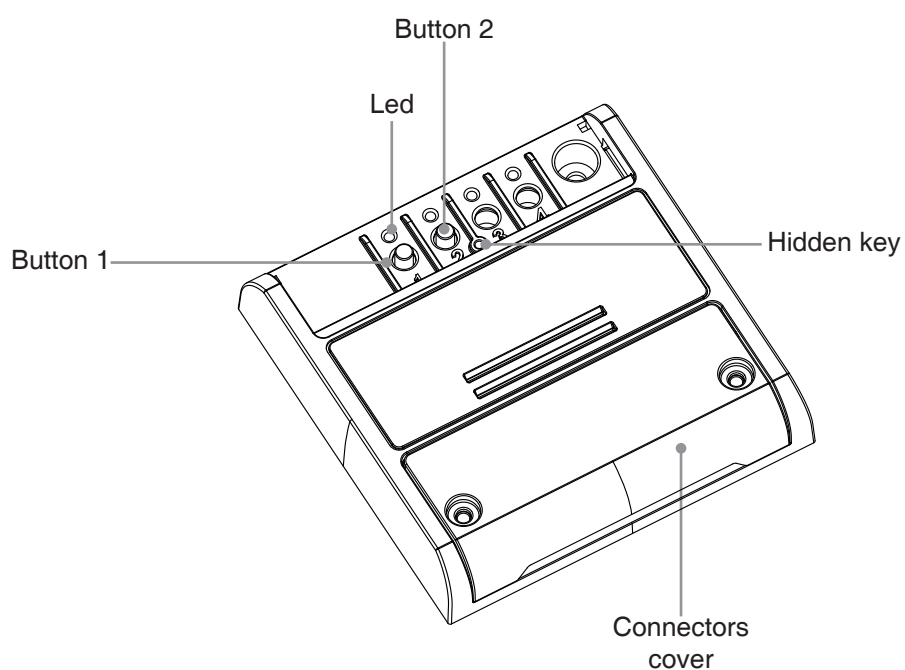

2 - CONNECTION DIAGRAMS

RECOMMENDATIONS

- Installation must be carried out only by professional technicians in accordance with the applicable electrical and safety regulations.
- All connections shall be operated without electrical voltage.
- Use proper cables.
- Don't cut the antenna
- Provide in the power line with an appropriate disconnection device
- Dispose of waste materials in full compliance with local law.
- Do not exceed the specified load limits and use correctly protected power supplies.

2.1 CONNECT THE START CONTACT

Start contact must be connected to the “start contact” of the automation control unit.

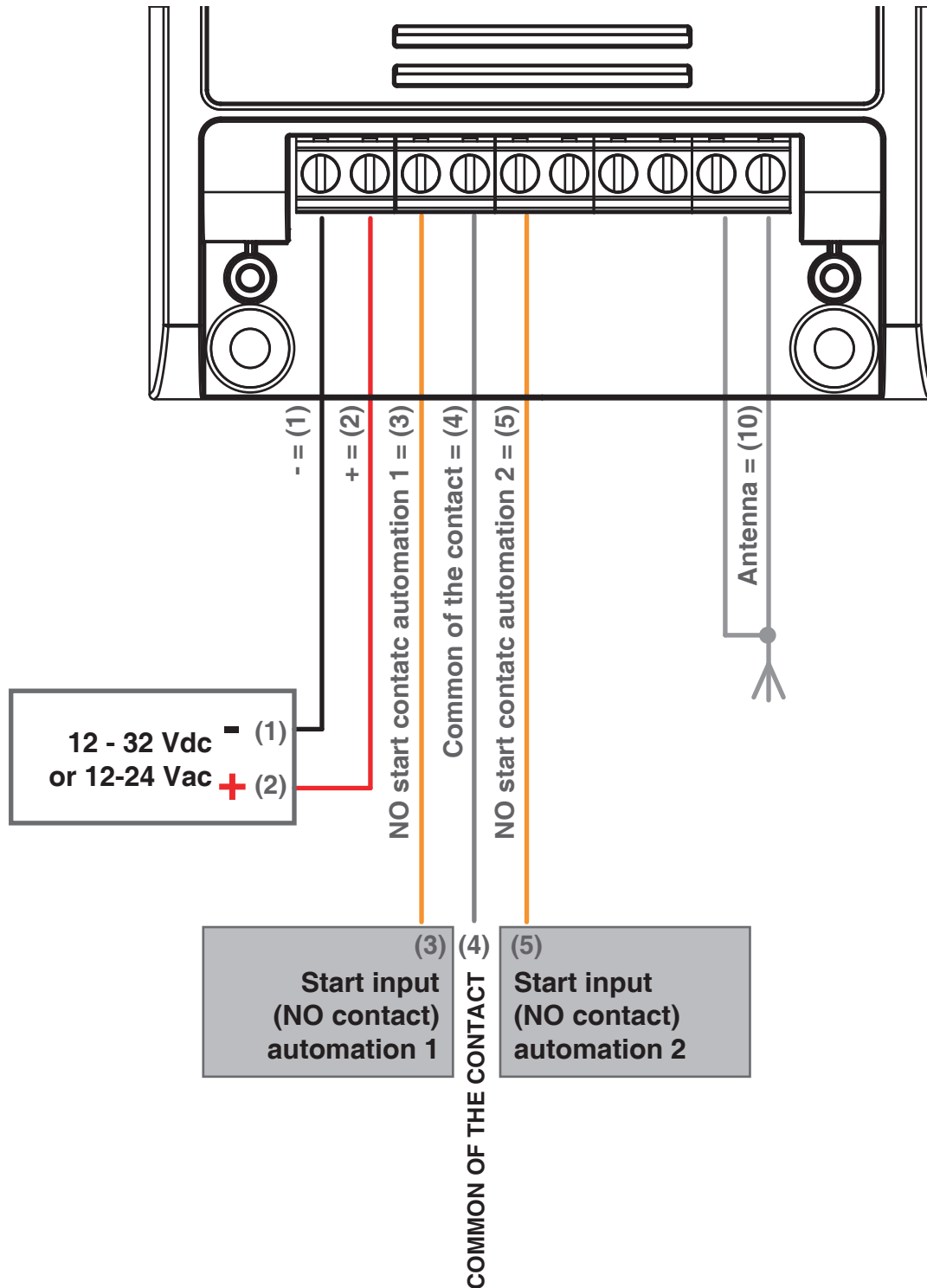

WARNING:

- Contact must be free of voltage

USE VIA WIRE

The start contact of the Plano control unit is connected in parallel to any wire commands (e.g. buttons or key selectors) directly to the automation control unit.

USE VIA RADIO TRANSMITTER

To send start command via radio transmitter, you need to program it on the Plano control unit, see paragraph 5

USE VIA APP

In order to send start commands from application, it is necessary to do the procedure for associating the control unit with the application, see paragraph 6.

Once the device is associated, it will be present on the home.

Once selected, automation can be remotely controlled:

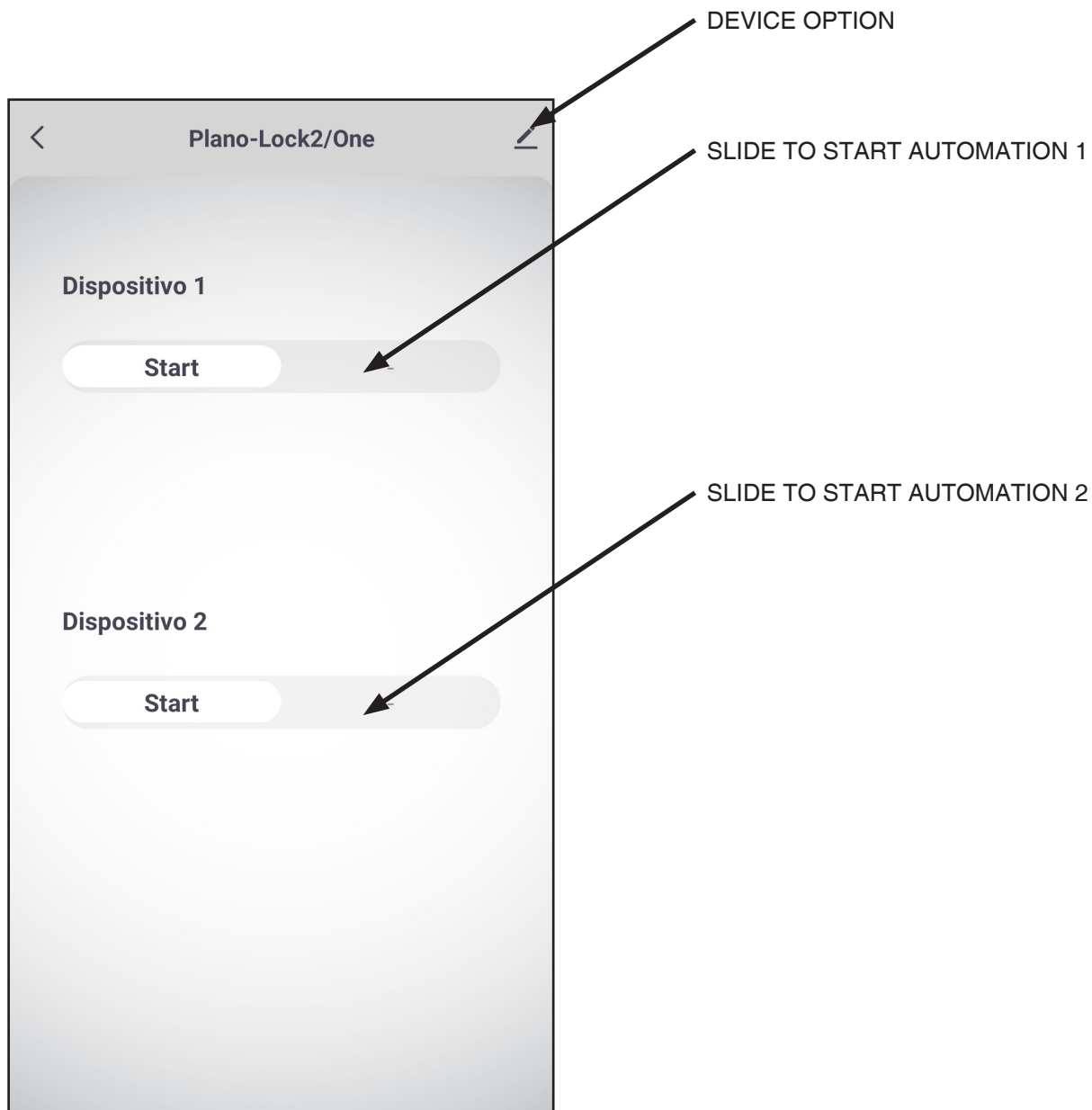

WARNING:

- The effect of the START command (open, close, open/stop/close) depends on the automation control unit settings

3 - USE OF THE CONTROL UNIT

3.1 TYPICAL INSTALLATION

The system can be controlled by a radio commands, smartphone App OneSmart or voice commands. The installation can operate with only radio controls or application only. Instead, to use voice commands, at least the App configuration must be completed.

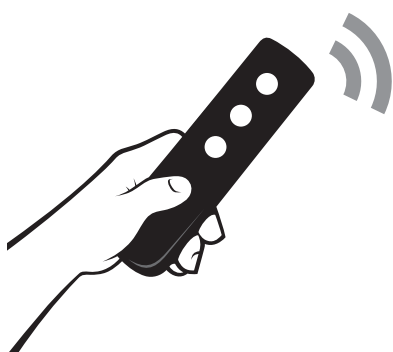

RADIOTRANSMITTER CONFIGURATION

See paragraph 4

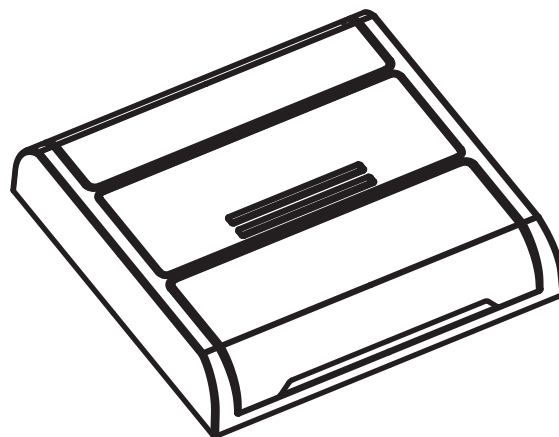

CONTROL UNIT

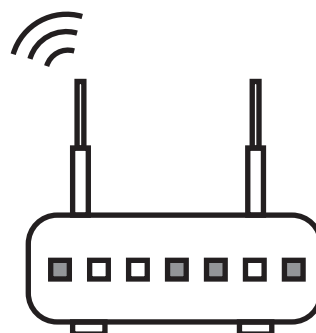

ROUTER WITH INTERNET
CONNECTION



APP CONTROL CONFIGURATION

See paragraph 5



VOICE CONTROL CONFIGURATION

See paragraph 6

3.2 USE VIA RADIO

To control the automation via radio you must have compatible transmitters and therefore must carry out the association procedure, see paragraph 4.

3.3 USE VIA SMARTPHONE APP ONESMART

The configuration procedures described in paragraph 5 above must be followed to control the lights by smartphone App.

3.4 USE WITH VOICE CONTROL

The configuration procedures described in paragraph 6 above must be followed to control the lights by voice commands.

4 - MANAGEMENT WITH REMOTE CONTROL

This procedure lets you programme/delete compatible 433.92MHz transmitters.

Multifunctional transmitters, codes:

With multifunctional transmitters the transmitter control modes depend on the model used.

Generic (wireless bus) transmitters, codes:

The functions of the generic transmitters is "start of the automation".

4.1 - RADIO PROGRAMMING

This procedure lets you programme compatible multifunctional or generic transmitters.

STEP 1

Press key 1 as many times as the output number on which you want to program the transmitter

no. of presses	LED colour	Output paired with TX
1	red	OUT1
2	green	OUT2
3	off	/

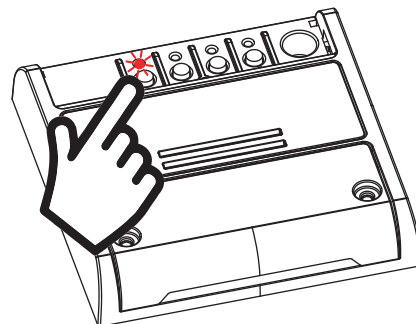

ACTION: Short press of button 1 **LED:** Turns on red/green

STEP 2

Within 60 seconds make a transmission with the transmitter to be saved.

See transmitter manual, the paragraph entitled "transmitter programming" for specify information.

The led makes 3 Flashes and turns off.



ACTION: Make a transmission with the transmitter **LED:** Flashes 3 times

4.2 - DELETION OF REMOTE CONTROL

These procedures let you delete from the memory transmitters that have already been programmed.

STEP 1

Hold the receiver button 1 down (about 5 seconds.) until the LED begins to Flash.

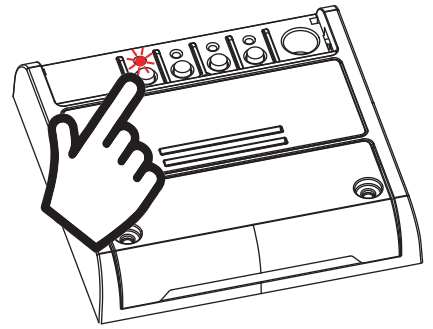

ACTION: Hold tbutton 1 down **LED:** Flashes red

**DELETION OF SINGLE
TRANSMITTER**

**DELETION OF ALL
TRANSMITTER SAVED**

STEP 2a

Within 10 seconds make a transmission with the transmitter that you want to delete.
The LED flashes quickly and turns off.

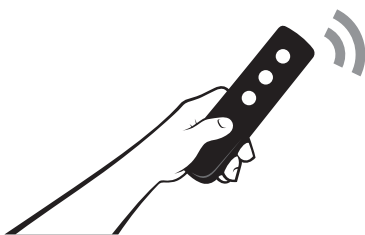
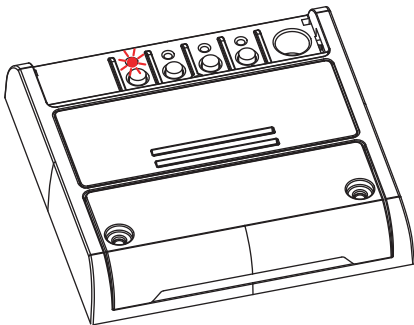

ACTION: Make a transmission with the transmitter
LED: Flashing quickly and turns off

STEP 2B

Within 10 seconds press the button 1 on the receiver for a short time to confirm the deletion of all transmitters.
The LED starts flashing quickly and turns off.

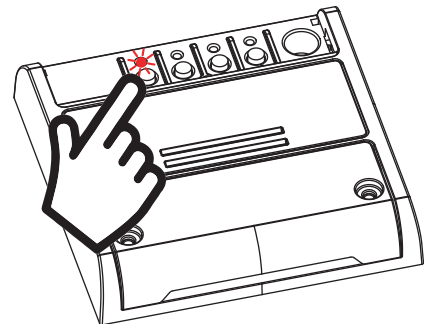

ACTION: Short press of button 1
LED: Flashing quickly and turns off

5 - CONTROL WITH APP ONE SMART

These procedures allow you to manage the light from your device (example: mobile phone) through the application and to control the system remotely.

5.1 - APP CONNECTION

This procedure connects the control unit Plano-One to the application. It shall be repeated for each control unit on the installation.

ATTENTION: an internet-based wi-fi network is required for te operation.

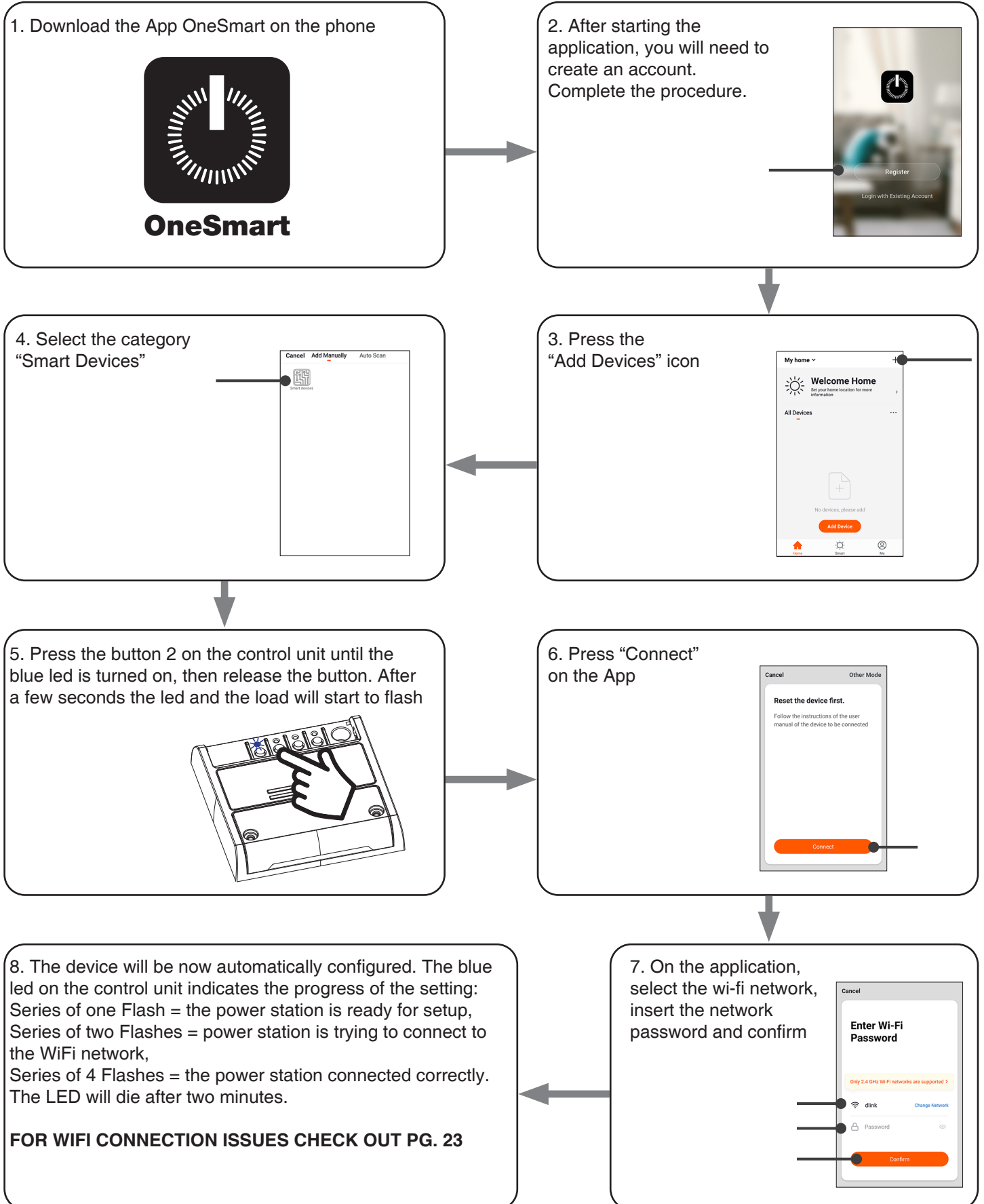

5.2 - USE OF THE APP ONE SMART

After all the control units have been set up, the installation can be managed by the application.

USE

The “Home” menu (1) shows all the associated devices.
To send a command to a device, select it.

Pressing “Smart” (2) allows you to add actions on your devices according to certain conditions and in certain time intervals, there are two types of actions:

- Automation (3): One or more actions happen if one or more conditions are satisfied
- Tap-to-Run (Scenario) (4): performs one or more actions by pressing an app button

EXAMPLES OF SCENARIOS (TAP-TO-RUN):

- Open the garage dorr and turn on the light

EXAMPLES OF AUTOMATIONS:

- Open the gate and when it's totally open, block it for ten minutes

Pressing “Me” (5) for entering to home and account settings.

From this menu, you can add members to the home for sharing device management or creating new houses.

PROCEDURE FOR ADDING NEW USERS/MEMBERS.

1- From the “ME” menu (5), select “Home Management” (7) and then go to the house configurations and find “Add Member”

2- Insert the “OneSmart” account you want to add (email or mobile phone number of the new member), the new member will receive a notification of the invitation.

WARNING:

- The new user must have already downloaded the “OneSmart” application and created an account.
- Both the ‘administrator’ and the ‘new user’ must have set the same ‘region’ (Country).
- (Go to “Account (2)-Account and Security-Region” to view and change the set country).

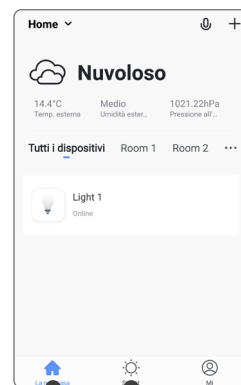

Home (1) Smart (2)

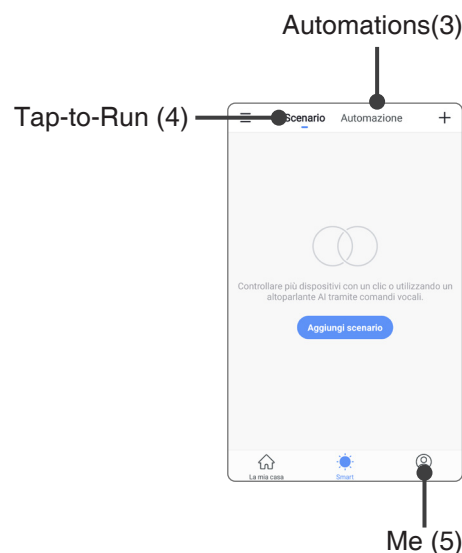

Me (5)

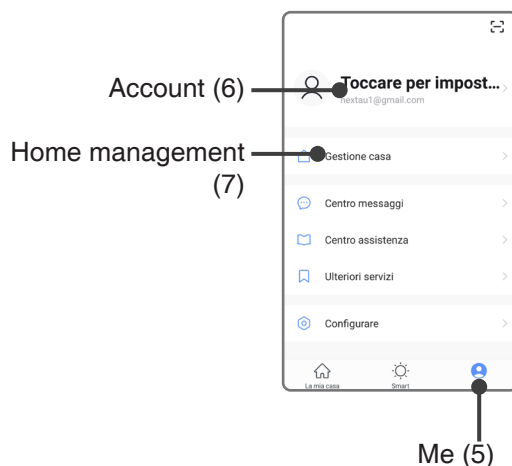

Me (5)

6 - CONTROL BY VOICE COMMANDS

You can use this procedure to associate a “OneSmart” account with a Google or Alexa account to enable the voice commands.

6.1 - CONNECTION TO “GOOGLE HOME”

PROCEDURE

WARNING: before proceeding with this procedure, you must have set up the “OneSmart” account, see paragraph 6.

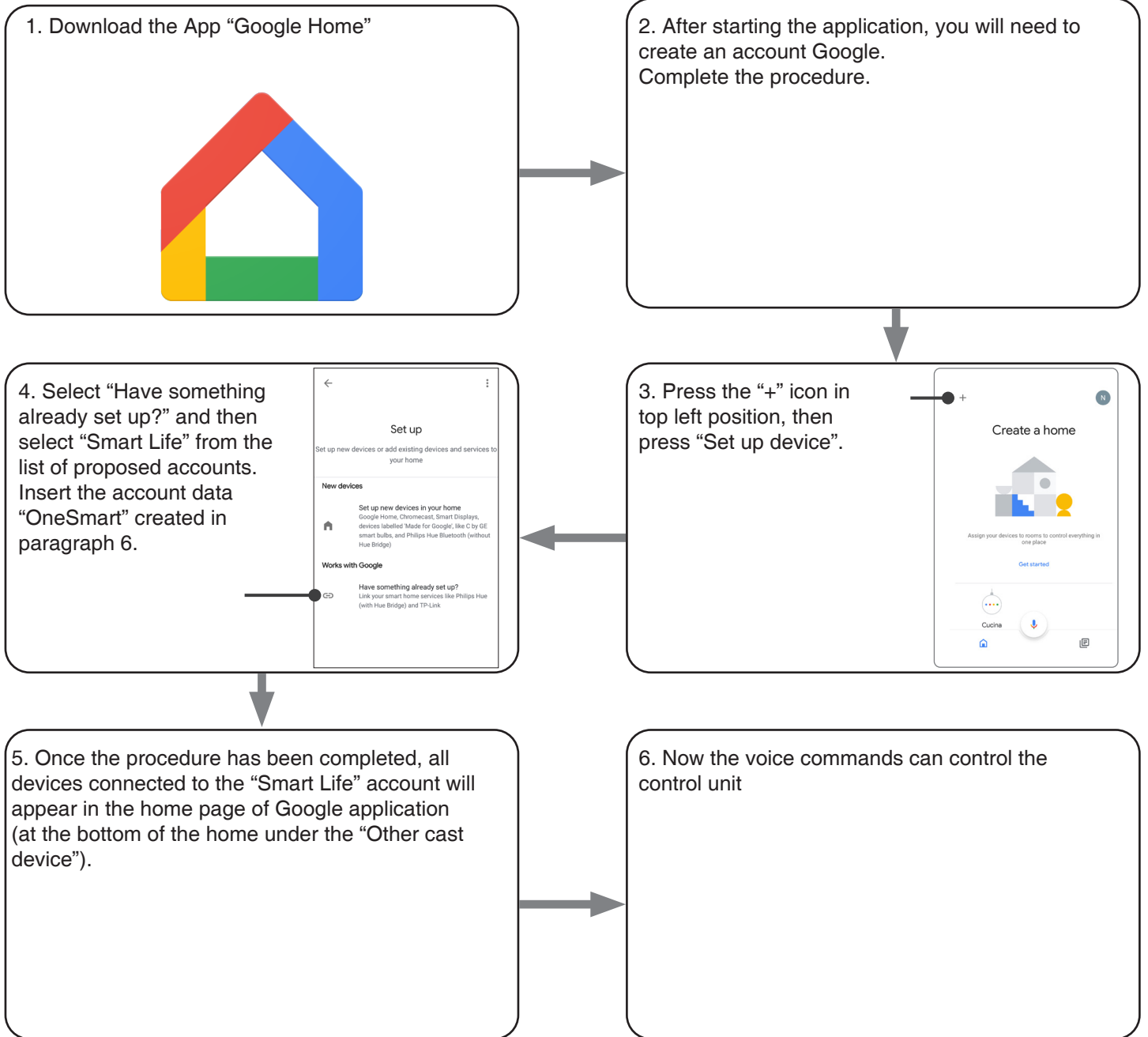

NOTES:

If you add other devices to your OneSmart application, they will automatically be added to the Google Home page. To use them with voice control, you need to add them to a room in the Google Home application, see step 6 of the procedure.

If devices are not added automatically, disconnect and reconnect your account from step 3 of this procedure from Google Home.

6.2 - COONNECTION TO “AMAZON ALEXA”

PROCEDURE

WARNING: before proceeding with this procedure, you must have set up the “OneSmart” account, see paragraph 6.

1. Download the App “Amazon Alexa”



2. After starting the application, you will need to create an account Amazon.
Complete the procedure.

3. From the application home page press “menu” (1) then “Skill and games” (2). Press on the “Magnifying glass” at the top right and then search for “Smart Life” (3). Follow the procedure to enable use of the “OneSmart” account created using paragraph 6

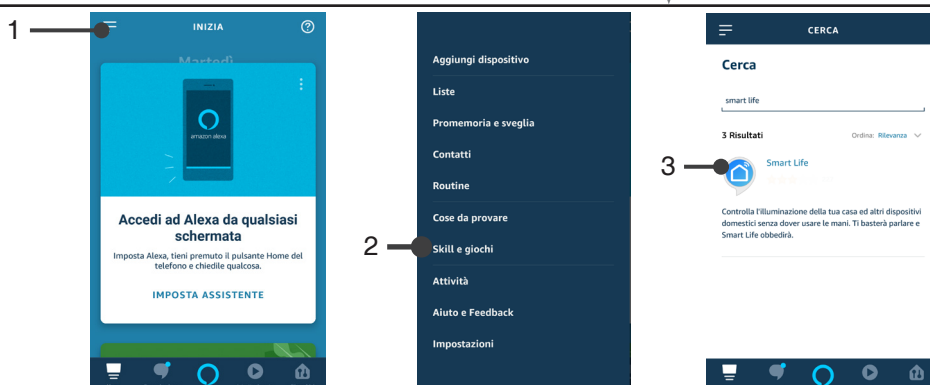

4. Complete the procedure by entering the “OneSmart” account data created in paragraph 6. You can then start searching for devices by pressing the “Discover devices” button (4). If you want, complete the setting-up procedure by inserting the device into a room.

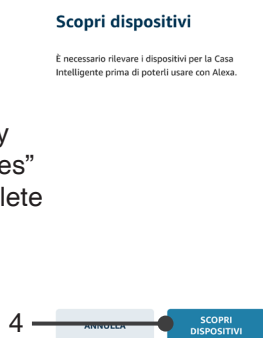

5. Now the voice commands can control the control unit

6.3 - USING VOICE CONTROLS

In order to set up voice commands, you must create a scene on OneSmart and then associate it with a Google or Alexa routine by choosing the phrase to pronounce to match the most appropriate action.

Speech controls for automation control depend on the operation of START contact at the automation plant.

6.3a - CREATING A SCENARIO ON ONE SMART

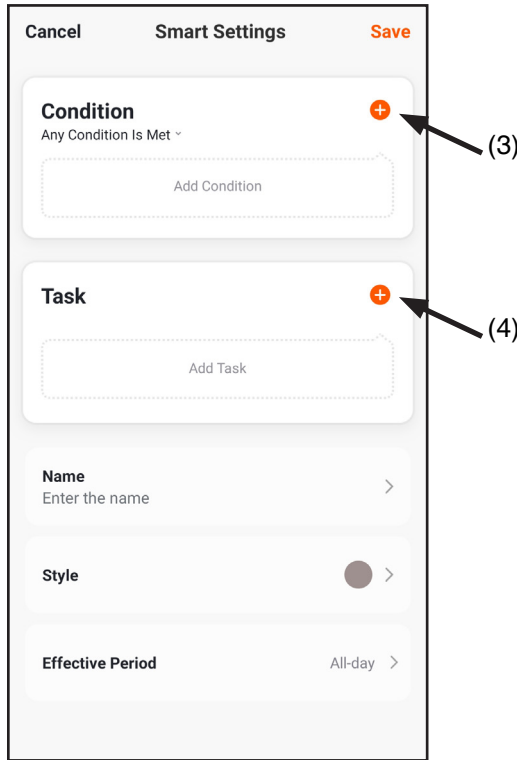
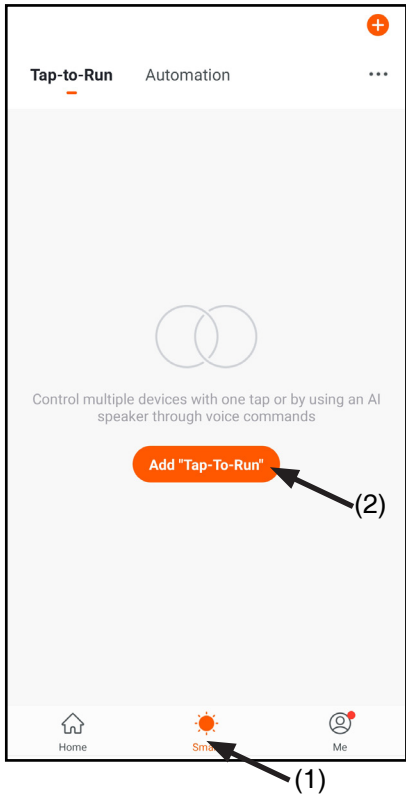

- On the OneSmart application go to the Smart window (1)
- Press "Add Tap to Run" (2)
- As a condition, select "Click to execute" (3)
- Select the device, then select the "Start" command (4)
- Rename and save

6.3b - CREATING A GOOGLE ROUTINE

- 1 - On the Google Home application, select Routines (1)
- 2 - Create a new routine and insert the phrase you want to pronounce to "Add Commands" (2)
- 3 - On "+ Add Action" (3), select "Browse popular actions" (4) and then "Adjust Scenes" (5)
- 4 - Select the scene created on One Smart in procedure 6.3a.

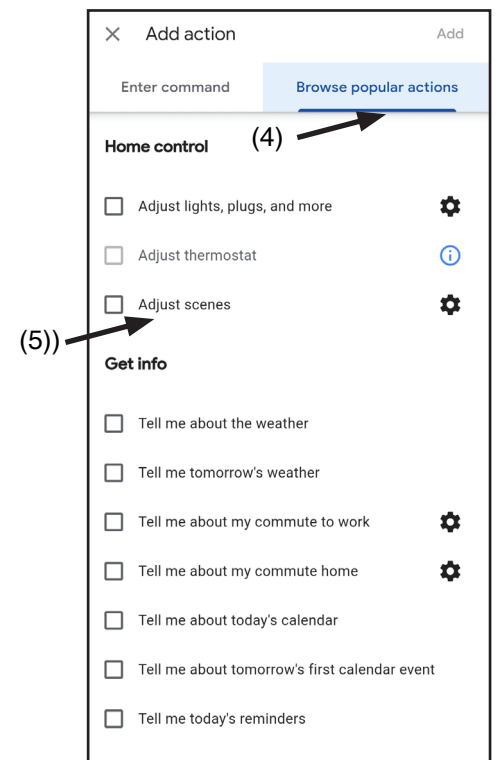
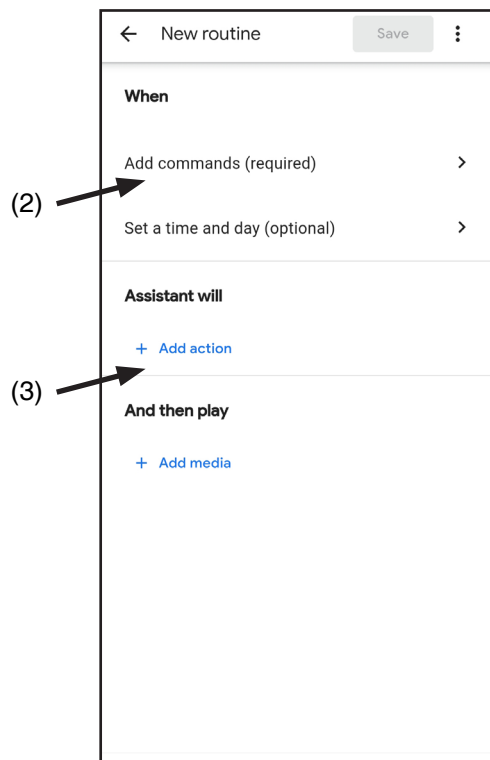
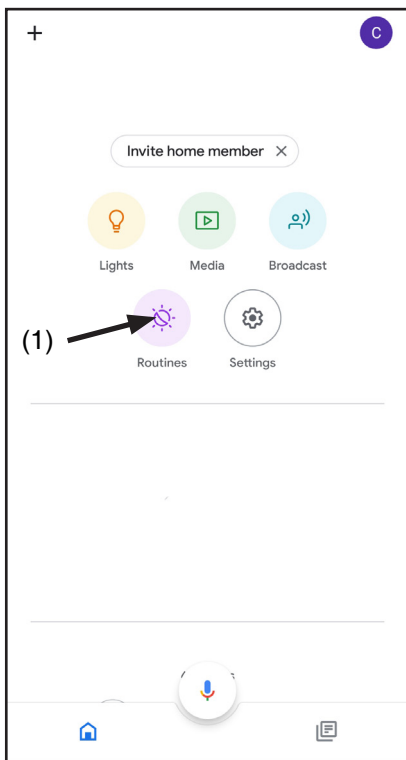

6.3c - CREATING A ALEXA ROUTINE

- 1 - On Alexa application, select the menu (1)
- 2 - Select "Routines" (2), and then add a new one
- 3 - Enter the name (3), the phrase you want to pronounce (4), and "add an action" (5) select "Smart Home", then select "Control scene". Select the scene created on One Smart in procedure 6.3a.

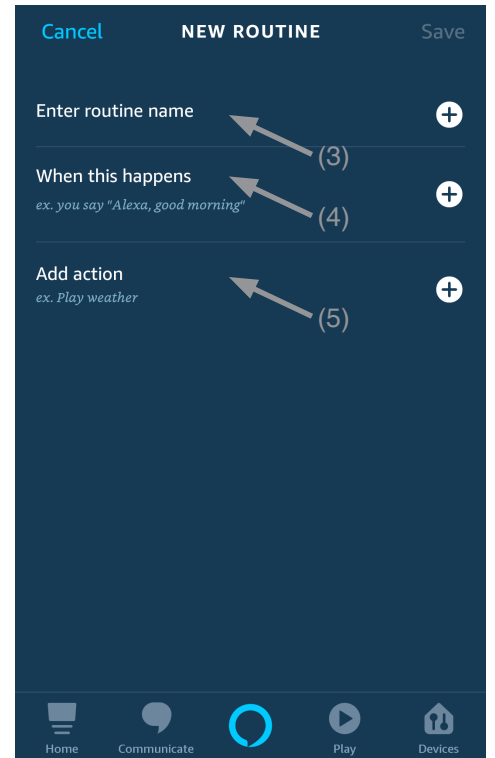
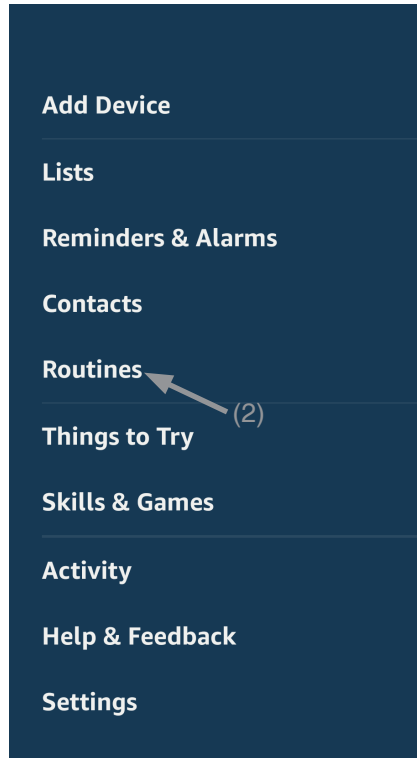
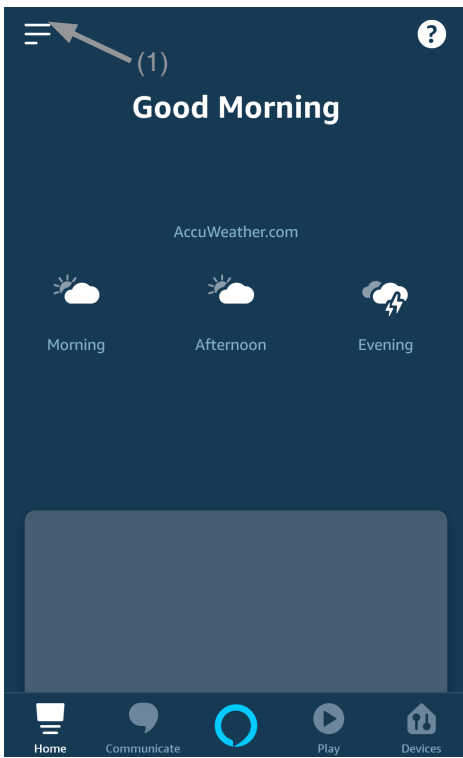

6.3c - DETAILED

The operation of the Start and therefore voice commands also depend on the operation of START contact in the automation control unit.

It is recommended to create voice commands consistent with the operation of the installation.

Voice command tips based on how the start works

START SET AS STEP-STEP (when it's close, open / when it's open, close / during the moving stops)

If automation is controlled without being visible, a generic command such as "start cacello/garage", "gate/garage" must be created

If you control automation by seeing its status, you can create multiple voice commands: "open the gate/garage", "lock the gate/garage" or "close the gate/garage".

All of these commands refer to the same action (closing the start contact).

Clearly if the gate is in motion and the "open gate" command is sent, it will stop.

START SET AS OPEN ONLY, CONDOMINAL FUNCTION (whatever automation status the start will open)

Suggested commands "Open Gate" or "Open Garage"

7 - ADVANCED PROGRAMS

VIEWING THE DOOR STATUS ON THE APP

To display the status of the door (open, closed, partially open) on the app, you must connect the contacts to the control unit.

The control unit can work with:

- **one normally closed contact with no voltage when opening**

typically this means there is one micro limit switch for when the door opens, connected to the relevant input (terminal 6, 7). When the door touches the microswitch, the contact must open; this turns on the green light in the app and turns off the other light.

- **one normally open contact with no voltage when opening**

typically this means there is one micro limit switch for when the door opens or closes, connected to the relevant input (terminal 6, 7). When the door touches the microswitch, the contact must close; this turns on the green light in the app and turns off the other light.

- **one normally open contact with 12-24 VDC**

typically this means there is a status light (12 or 24 VDC) for the connected door, connected to the relevant input (terminal 6, 7). When the status light is on, the green light also comes on in the app and the other light goes off, and vice versa.

ATTENTION: the control unit can also work with the limit switch of only one connected automation. it is important to enable only the limit switches actually connected with the procedure

NORMALLY CLOSED CONTACTS WITH NO VOLTAGE

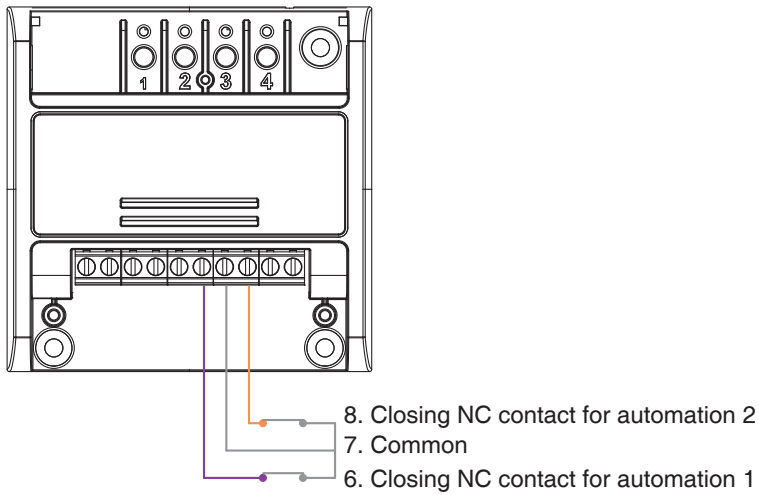

NORMALLY OPEN CONTACTS WITH NO VOLTAGE

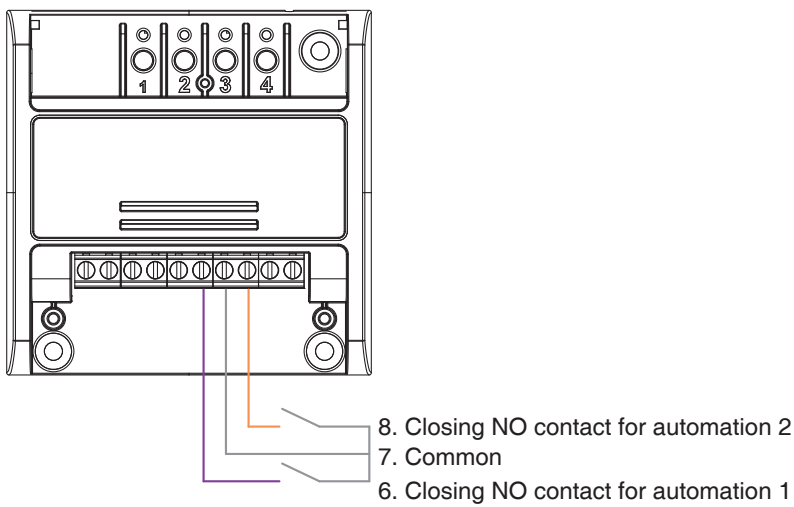

ONE CONTACT WITH 12-24 VDC (WARNING LIGHT)

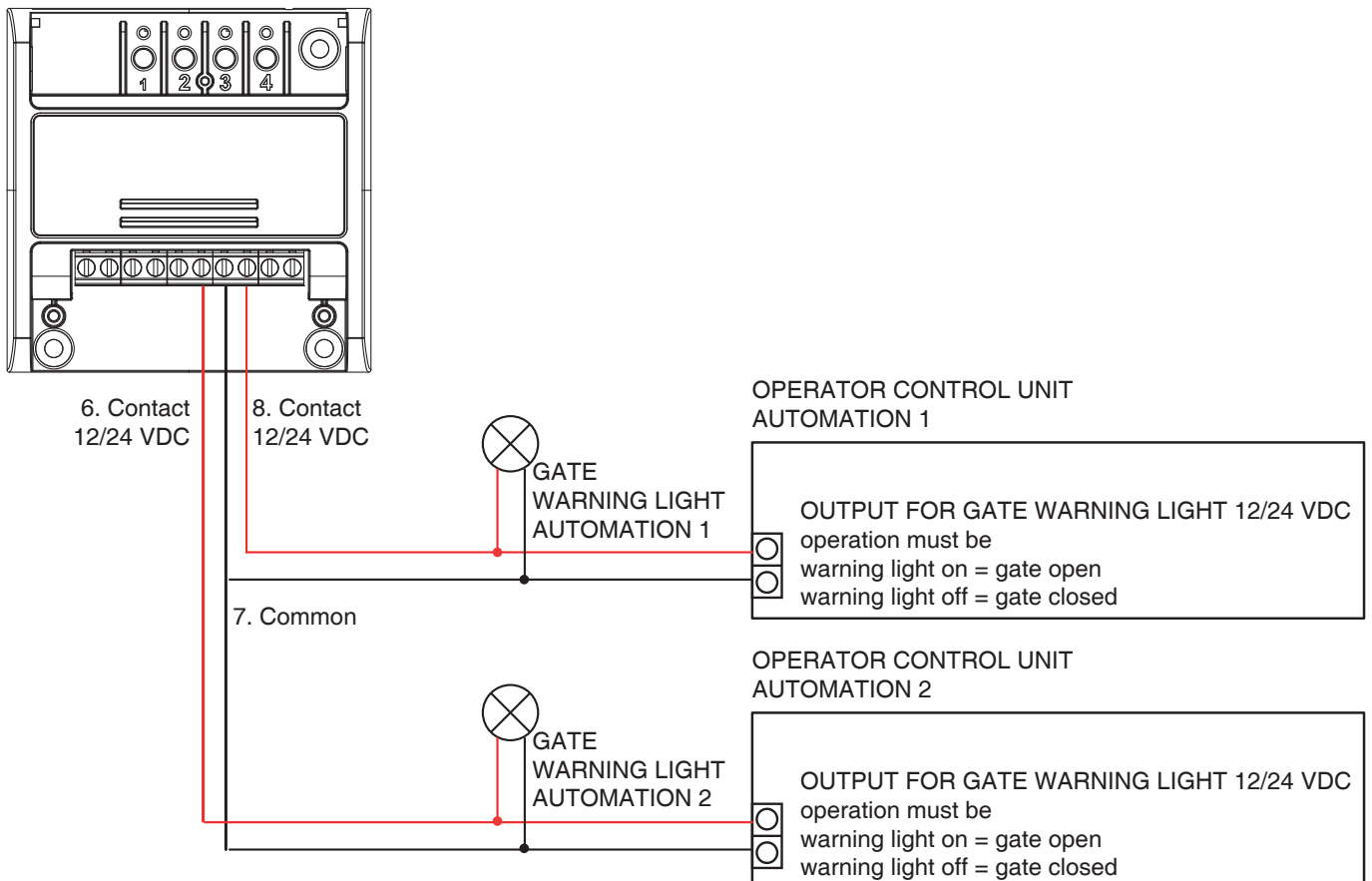

7.1 - SETTING THE CONTACT FOR LIMIT SWITCHES

Default: No limit switches

This procedure is used to set the type of contacts of limit switches.

PROCEDURE

STEP 1

With a paper clip makes a long press of the "hidden" button.
The LED turns on light blue/pink/yellow cyclically.
Release the key when the led is light blue.

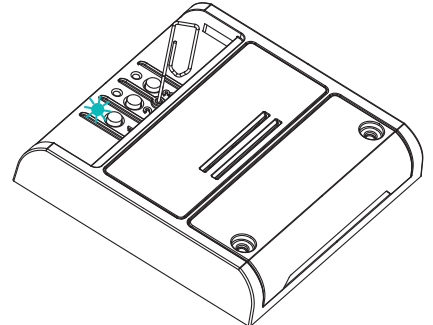

STEP 2

Press the button 1 on the receiver for a short time and count the number of Flashes emitted by the LED:

FLASHES NUMBER	FUNCTION
1	No limit switches
2	NC contact
3	NO contact
4	Management with radio position sensor *

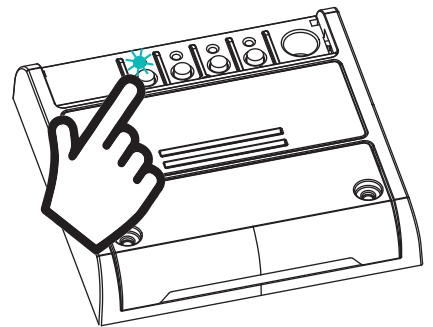

ACTION: Short press of button 1
LED: Count the number of Flashes

STEP 3

Press the button for a short time during the Flash that corresponds to the function desired to end the count.
The led turns off

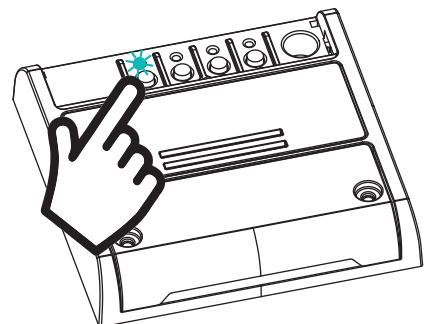

ACTION: Short press of button 1
LED: Turns off

* the position sensor is an accessory that must be purchased separately

7.2 - SETTING THE CONTACT FOR LIMIT SWITCHES

Default: No limit switches

This procedure is used to set the type of contacts of limit switches.

PROCEDURE

STEP 1

With a paper clip makes a long press of the "hidden" button.
The LED turns on light blue/pink/yellow cyclically.
Release the key when the led is light blue.

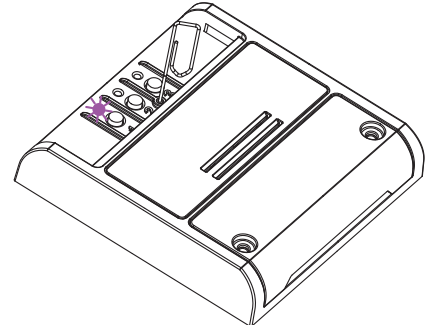

STEP 2

Press the button 1 on the receiver for a short time and count the number of Flashes emitted by the LED:

FLASHES NUMBER	FUNCTION
1	No limit switches
2	NC contact
3	NO contact
4	Management with radio position sensor *

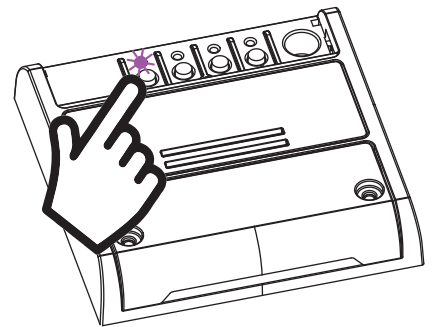

ACTION: Short press of button 1
LED: Count the number of Flashes

STEP 3

Press the button for a short time during the Flash that corresponds to the function desired to end the count.
The led turns off

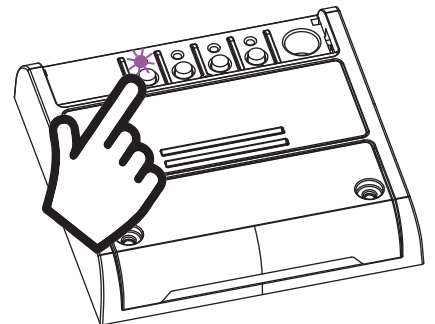

ACTION: Short press of button 1
LED: Turns off

* the position sensor is an accessory that must be purchased separately

7.3 - SETTING OF THE CONTACT TYPE OF THE LIMIT SWITCHES AS WARNING LIGHT FOR AUTOMATION 1 AND 2

With the following procedure it is possible to set the type of contact for both automations as a warning light.

PROCEDURE

STEP 1

With a paper clip makes a long press of the “hidden” button.
The LED turns on light blue/pink/yellow cyclically.
Release the key when the led is light yellow.

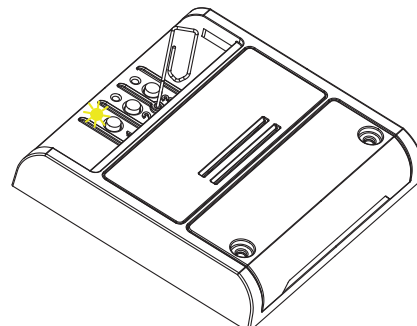

STEP 2

Press the button 1 on the receiver for a short time

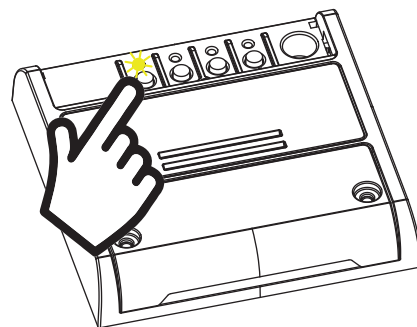

ACTION: Short press of button 1
LED: Count the number of Flashes

NOTE:

if with limit switch in warning light mode a mode other than warning light is set for automation 1 or automation 2 (see procedura 7.1 and 7.2), the other limit switch is set to “no limit switch” mode

7.4 - RESET OF THE CONTROL UNIT

This procedure let you take the control unit back to factory settings.

ATTENTION: the only parameter that will not be removed will be the association with the ONESMART application.
To edit or delete also this parameter, reed the procedure.

PROCEDURE

STEP 1

Hold the receiver button P1 down (about 4 seconds.) until the LED begins to Flash.

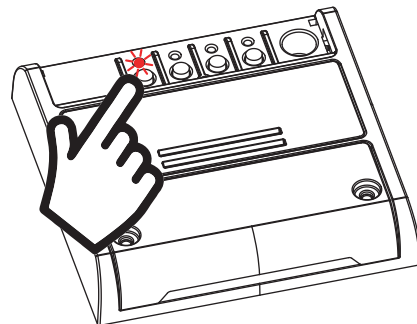

ACTION: Hold button RADIO down **LED:** Flashes red



STEP 2

Within 10 seconds, make a short press of hidden button.
The LED 1 Flashes quickly and turns off.

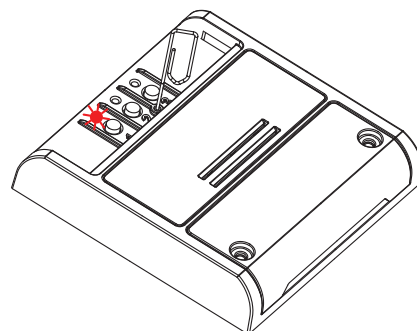

AZIONE: Short press of Wi Fi button **LED:** the led Flash quicly and turns off

8 - INSIGHTS

8.1 – ISSUES WHEN CONNECTING THE CONTROL UNIT WITH WIFI

If you're having problems connecting the control unit to the router, we suggest to:

FIRST CHECKS:

- check if the network used to connect the control unit is running at 2.4GHz (not 5GHz)
- the smartphone you use must be connected to the same WiFi on which you want to connect the device
- please check if the entered password is correct

STEPS TO DO:

- close the app and try again to connect the device
- if possible try with another smartphone to check if it works

If the problem is not fix, there may be some settings in your router that make the network incompatible with the device. To check and change these settings it's necessary to access the router settings.

As soon as you access the router settings (it depends on the model of router you have) try to check and set these parameters:

WIFI FREQUENCY BAND

some routers generate a network that is set automatically at a frequency of 2.4GHz or 5GHz, depending on the device you are connecting with. When you are trying to connect the device through your OneSmart account, your smartphone may be connected automatically at the frequency band of 5GHz, failing the connection with your device.

It's therefore necessary to access the router settings and set the 2.4GHz as the main network frequency to use.

Otherwise it's possible to create two different WiFi networks, one for the 2.4GHz and one for the 5GHz band, and during the pairing phase make sure your smartphone is connected to the 2.4GHz network.

WIFI SECURITY SETTINGS

some routers could have default security settings not compatible with the device.

Please find out which security protocol type your Wi-Fi router is and change it to:

WI-FI SECURITY:

SECURITY TYPE: WPA2
ENCRYPTION TYPE: AES



V1.2

Nexta Tech

company brand of Team srl
via G.Oberdan 90, 33074
Fontanafredda (PN) - Italy
Ph. +39 0434 998682
Email: info@nexta-tech.com
Web: www.nexta-tech.com